

# Clinical Procedure Guide for TOKUYAMA BOND FORCE

- Read instructions before operation.
- Veuillez vous référer au mode d'emploi avant utilisation.
- Vor der Anwendung die Gebrauchsanweisung lesen.
- Lea las instrucciones antes del uso.
- Leggere le istruzioni prima dell'uso.
- Less de aanwijzingen voor gebruik.

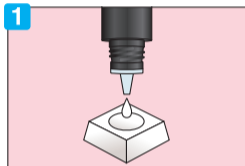

Dispense



Apply BOND FORCE



Then rub the margins

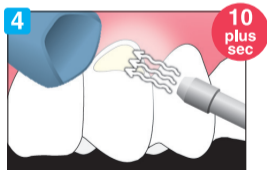

Apply weak air (5sec)  
→ Strong air (5+sec)\*

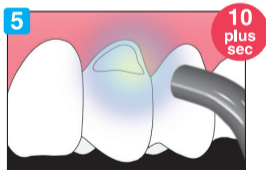

Light cure

\*Note: If accidental spattering of the material occurs, it may cause the tissue to whiten or a possible allergic reaction.  
To prevent spattering, refer to the instruction sheet.